



## Pipe Welding (2G and 5G Welding)

### Project 1 – Specification and Print

<b>Weld Type</b>	CJP Groove
<b>Welding Process</b>	SMAW or GTAW
<b>Position</b>	Horizontal
<b>Material</b>	3" Sch. 80 Pipe
<b>Joint Type</b>	Vee Butt
<b>Backing Option</b>	No Backer
<b>Backing Material</b>	

<b>Polarity</b>	DC+
<b>Electrode</b>	E6010 3/32, E7018 3/32
<b>Transfer Mode</b>	
<b>Tungsten Electrode</b>	Or 2% Ceriated
<b>Shielding Gas</b>	100% Argon
<b>Flow Rate</b>	25cfh
<b>Cup Size</b>	

Welding Procedure									
Weld Layers	Pass No.	Process	Filler Metal Classification	Filler Metal Diameter in (mm)	Current Amps	Current Type and Polarity	Wire Feed Speed	Volts	Remarks
Stringer	root	SMAW	E6010	3/32	50a	DC+			
	fill	"	E7018	3/32	75a	"			
	cover	"	E7018	3/32	75a	"			
Stringer	Root & Fill	GTAW	ER70s-6	1/16 or 3/32	120a	"			





---

## **Pipe Welding (2G and 5G Welding)**

### *Project 1 – Specification and Print*

---

#### **Heat Treatment:**

**Preheat Temperature:**

**Post Heat Temperature:**

**Interpass Temperature:** Quench between passes

**Stress Relieving:**

**Technique:** SMAW- Root Pass performed with E6010 3/32 for CJP. Fill and Cover Passes performed with E7018 3/32.

GTAW- Root/Fill/Cover use ER70s-6 1/16" or 3/32" filler metal

Initial/Interpass Cleaning- Chip and Brush

**Additional Notes:** Show instructor progress every 30 minutes minimum.





## Pipe Welding (2G and 5G Welding)

### Project 1 – Specification and Print

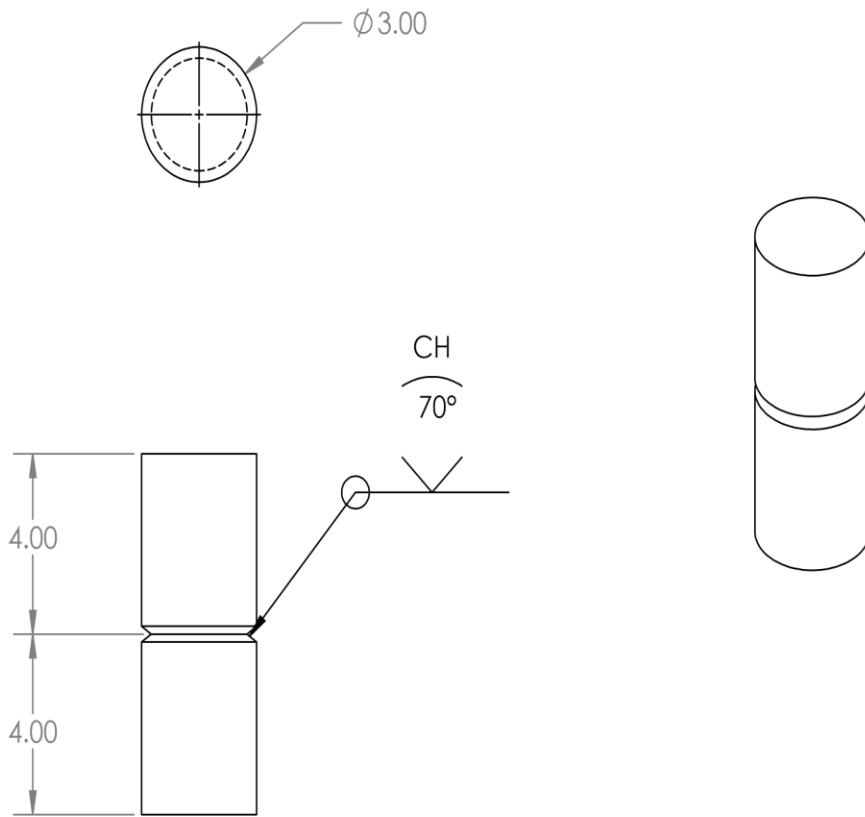

**NOTES:** FLAME CUT BEVEL  
3/32 LAND  
6010 3/32 ROOT  
7018 3/32 FILL & COVER

**SolidWorks Educational Edition.  
For Instructional Use Only.**

PROPRIETARY AND CONFIDENTIAL  
THE INFORMATION CONTAINED IN THIS DRAWING IS THE PROPERTY OF  
<INSERT COMPANY NAME HERE>. ANY  
REPRODUCTION OR TRANSMISSION  
WITHOUT THE WRITTEN PERMISSION OF  
<INSERT COMPANY NAME HERE> IS  
PROHIBITED.

		UNLESS OTHERWISE SPECIFIED:	NAME	DATE		
		DIMENSIONS ARE IN INCHES	DRAWN	J.SIBERT	3/27/2015	TITLE:  CIMWD-210 project 1
		TOLERANCES:	CHECKED			
		FRACTIONAL ±	ENG APPR.			
		ANGULAR: MACH ± BEND ±	MFG APPR.			
		TWO PLACE DECIMAL ±	Q.A.			
		THREE PLACE DECIMAL ±	COMMENTS:			
		INTERPRET GEOMETRIC TOLERANCING PER:				
		MATERIAL				
		FINISH				
		USED ON				
		APPLICATION				
		DO NOT SCALE DRAWING				
5	4	3	2	1		
			SIZE	DWG. NO.	REV	
			<b>A2G Drawing</b>		<b>0</b>	
			SCALE: 1:4	WEIGHT:	SHEET 1 OF 1	





---

## **Pipe Welding (2G and 5G Welding)**

### *Project 1 – Specification and Print*

---

#### **SAFETY DISCLAIMER:**

M-SAMC educational resources are in no way meant to be a substitute for occupational safety and health standards. No guarantee is made to resource thoroughness, statutory or regulatory compliance, and related media may depict situations that are not in compliance with OSHA and other safety requirements. It is the responsibility of educators/employers and their students/employees, or anybody using our resources, to comply fully with all pertinent OSHA, and any other, rules and regulations in any jurisdiction in which they learn/work. M-SAMC will not be liable for any damages or other claims and demands arising out of the use of these educational resources. By using these resources, the user releases the Multi-State Advanced Manufacturing Consortium and participating educational institutions and their respective Boards, individual trustees, employees, contractors, and sub-contractors from any liability for injuries resulting from the use of the educational resources.

#### **DOL DISCLAIMER:**

This product was funded by a grant awarded by the U.S. Department of Labor's Employment and Training Administration. The product was created by the grantee and does not necessarily reflect the official position of the U.S. Department of Labor. The Department of Labor makes no guarantees, warranties, or assurances of any kind, express or implied, with respect to such information, including any information on linked sites and including, but not limited to, accuracy of the information or its completeness, timeliness, usefulness, adequacy, continued availability, or ownership.

#### **RELEVANCY REMINDER:**

M-SAMC resources reflect a shared understanding of grant partners at the time of development. In keeping with our industry and college partner requirements, our products are continuously improved. Updated versions of our work can be found here: <http://www.msamc.org/resources.html>.

