

### **Proprietary Materials Disclosure**

Washburn Institute of Technology Renovation Plans were developed by Schwerdt Design Group, Inc. This material is proprietary.



Renovation Plans by Schwerdt Design, Inc is licensed under a [Creative Commons Attribution-NonCommercial-NoDerivatives 4.0 International License](https://creativecommons.org/licenses/by-nc-nd/4.0/).

This workforce product was funded by a grant awarded by the U.S. Department of Labor's Employment and Training Administration. The product was created by the grantee and does not necessarily reflect the official position of the U.S. Department of Labor. The U.S. Department of Labor makes no guarantees, warranties, or assurances of any kind, express or implied, with respect to such information, including any information on linked sites and including, but not limited to, accuracy of the information or its completeness, timeliness, usefulness, adequacy, continued availability, or ownership.

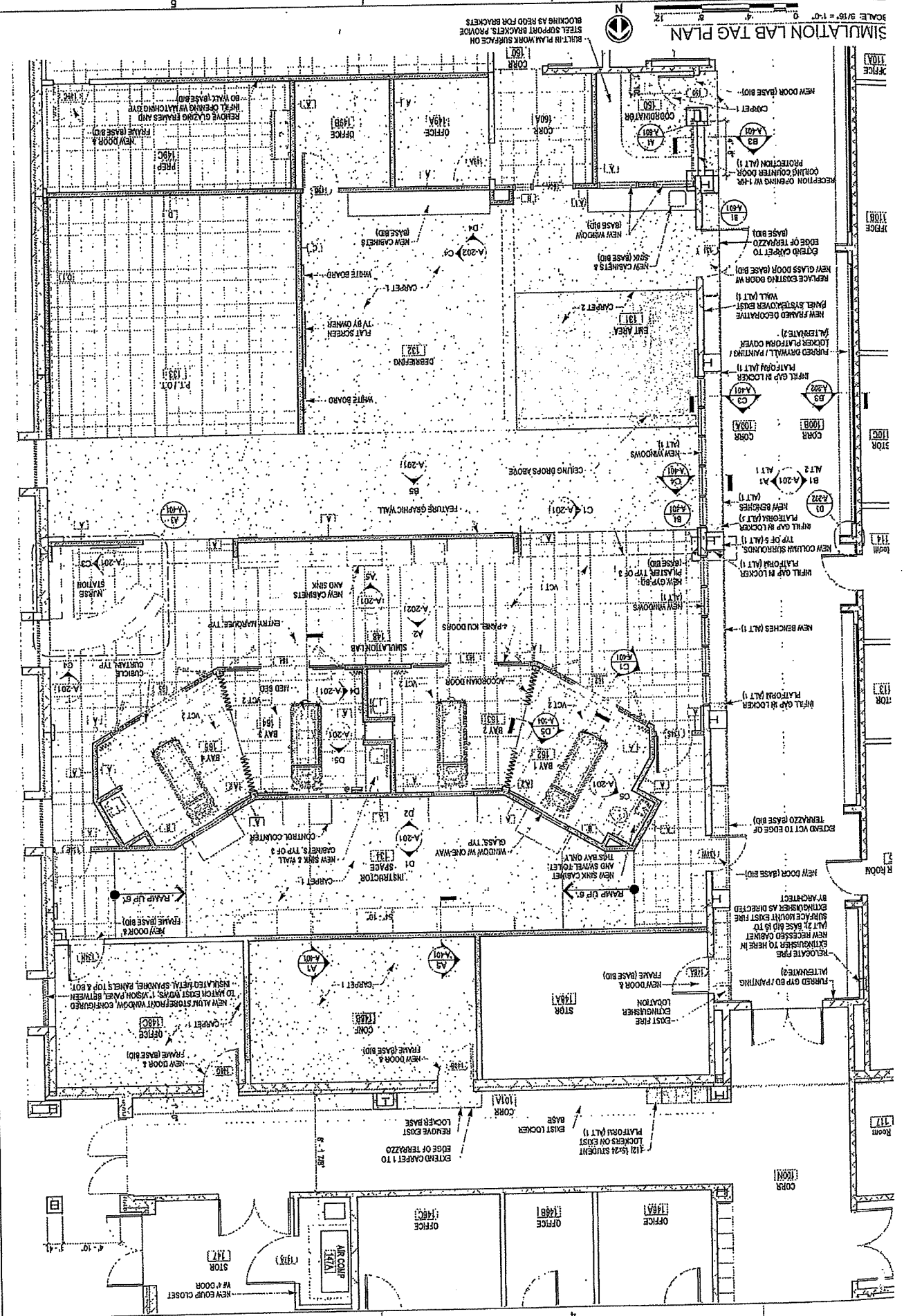

SHEET TITLE  
SIMULATION LAB TAG  
PROJECT NUMBER  
141120  
SHEET NUMBER  
A-102

WASHBURN INSTITUTE OF TECHNOLOGY  
REGIONAL SIMULATION CENTER  
5724 SW HUNTOON ST., TOPEKA, KS 66604-2117  
WIT #KTTTECH

DLR Group

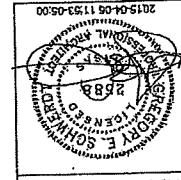

SCHERFDI  
design group, inc.  
2221 W. WYANDOTTEN BLVD. #103  
TOPEKA, KANSAS 66604-2117  
PH: 785-843-1234  
FAX: 785-843-1234  
2015-04-08 11:53-05:00