

Directions:

1. Cut 4 pcs .210 Alum. 1.5x4 inches
2. Tack and weld in any order
3. Debur test
4. Place ID number according to print
5. Turn in with grading sheet

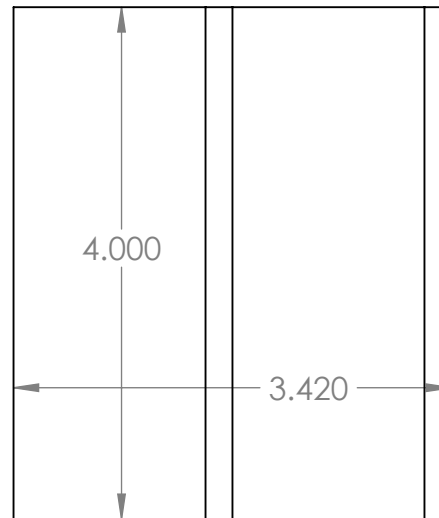

Place ID number here

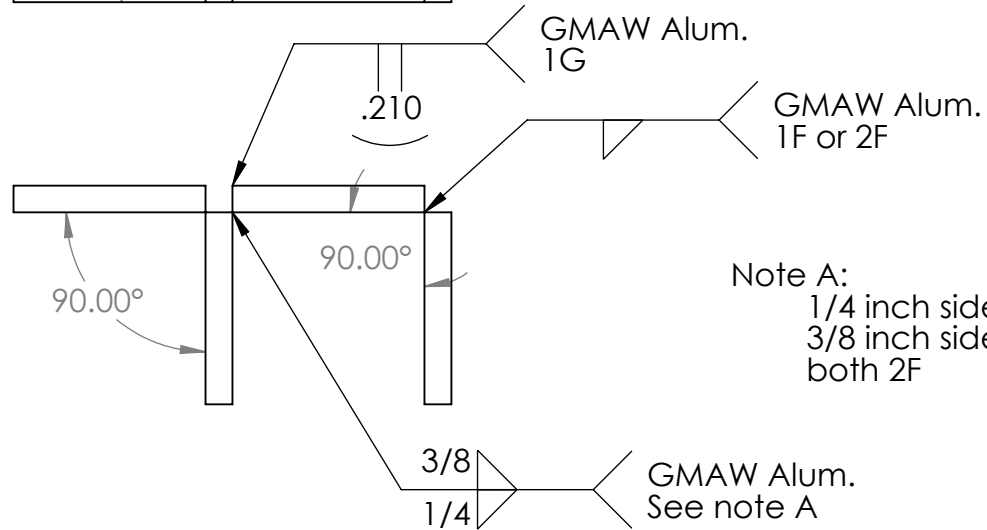
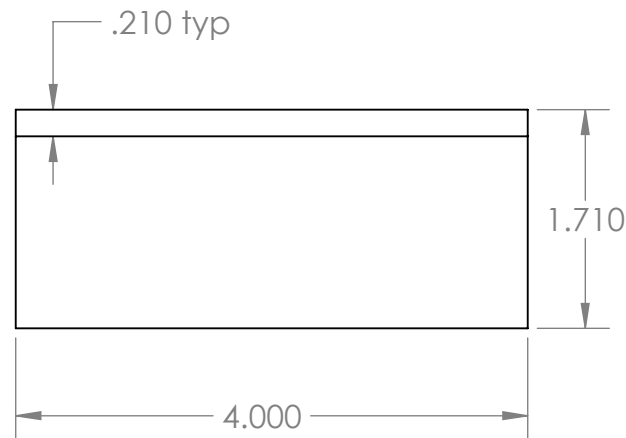
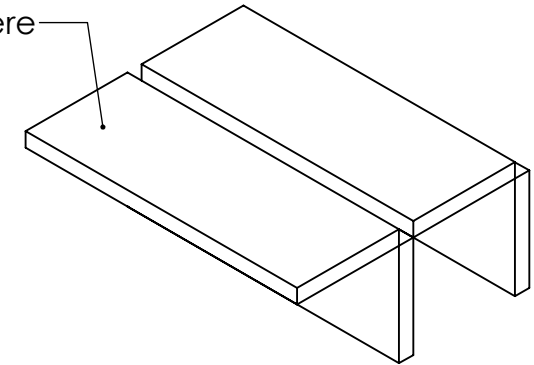

Note A:
1/4 inch side single pass
3/8 inch side triple pass
both 2F

PROPRIETARY AND CONFIDENTIAL
THE INFORMATION CONTAINED IN THIS DRAWING IS THE SOLE PROPERTY OF NDSCS. ANY REPRODUCTION IN PART OR AS A WHOLE WITHOUT THE WRITTEN PERMISSION OF NDSCS IS PROHIBITED.

		UNLESS OTHERWISE SPECIFIED:	NAME	DATE		
		DIMENSIONS ARE IN INCHES TOLERANCES: FRACTIONAL $\pm 1/16$ ANGULAR: BEND ± 1 degree TWO PLACE DECIMAL $\pm .01$ THREE PLACE DECIMAL $\pm .001$	DRAWN	CP	3/16	TITLE: GMAW Alum. Test
			CHECKED			
			ENG APPR.			
			MFG APPR.			
			Q.A.			SIZE A
			COMMENTS:			
NEXT ASSY	USED ON	MATERIAL	DWG. NO.			
		FINISH	REV			
APPLICATION		DO NOT SCALE DRAWING	SCALE: 1:2			
			SHEET 1 OF 2			

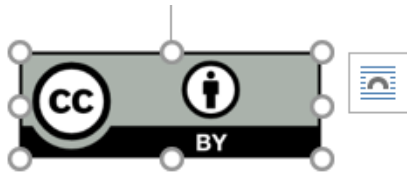

This work is licensed under the Creative Commons Attribution 4.0 International License. To view a copy of this license, visit <http://creativecommons.org/licenses/by/4.0/>

Disclaimer

This workforce product was funded by a grant awarded by the U.S. Department of Labor's Employment and Training Administration. The product was created by the grantee and does not necessarily reflect the official position of the U.S. Department of Labor. The U.S. Department of Labor makes no guarantees, warranties, or assurances of any kind, express or implied, with respect to such information, including any information on linked sites and including, but not limited to, accuracy of the information or its completeness, timeliness, usefulness, adequacy, continued availability, or ownership.

Aluminum GMAW Log

Objectives:

1. Demonstrate how to properly set up an aluminum GMAW welding station
2. Explain the effect electrode extension has on GMAW aluminum welding
3. Demonstrate how to properly make aluminum GMAW welds in all positions

Grading:

1. You must have no less than 6 hours recorded to pass.
2. You must complete the aluminum GMAW test and hand in the test grading sheet

Date	Filler Wire Used	Welding Position	Time